

12 and 24 Volt DC Continuous Duty Truck Vibrators



These Industrial Vibrators are Ideal for:
 Dump and Hopper Trucks
 Fertilizer Spreaders
 Seed Tenders
 Feed Hoppers
 Concrete Pump
 Salt Spreader Hoppers

Improve Productivity - more material delivered per load
Improve Safety - helps ensure even unloading
Eliminate Hammer Damage - vibrator does it all

- These newly designed **Continuous Duty DC Truck Vibrators** tolerate heavy loads without excessive amp draw. They keep working until you get the job done!
- Great improvements in DC motors help these motors achieve high torque with *reserve power*.
- Heavy loads will not slow down this new DC motor design. Typically the heavier the load on the motor, the slower the motor rotates, drawing more amps, which can destroy a motor, but not with this Continuous Duty DC Industrial Vibrator.
- This DC Motor design uses ball bearings, instead of sleeve bearings. Ball bearings allow for continuous duty operation.
- Accessible, easy-to-change motor brushes.
- Three sizes in the Continuous Duty models in either 12-volt or 24-volt.
- Comes complete with an intermittent or continuous duty switch and cables - everything you need to install on your truck, spreader, tender, or hopper.
- Optional hydraulic vibrator fits same bolt hole pattern.

12 and 24 Volt DC Continuous Duty Vibrators Performance Data					
VIBRATOR MODELS	Unbalance	Speed	Force	Voltage	Amp Draw
	lb /in	rpm	lb	volts	amps
	kg/mm		kN	12V or 24V	
CEG-400-12	0.55	5400	455	12V DC	25
CEG-400-24	63		2.03	24V DC	13
CEG-800-12	1.02	5400	845	12V DC	25
CEG-800-24	118		3.76	24V DC	13
CEG-1200-12	1.44	5400	1193	12V DC	25
CEG-1200-24	166		5.03	24V DC	13

Force output is determined by the speed the motor rotates. Motor speed can be affected by the type and quality of the mount and the load on the motor. Follow manufacturer's guidelines for optimum performance.

Truck Body Type	Capacity of Bed yd ³ (unless noted)	Typical Material Characteristics	
		Occasional Hang-ups Flows Mostly by Gravity	Wet or Sticky Seldom Flows by Gravity
		Recommended Truck Vibrator	
Tandem or Multi-axle	15-30	CEG-3200	CEG-4200
Rear Dump	8 - 16	CEG-2000	CEG-3200
	5 - 10	CEG-1200	CEG-2000
	2 - 5	CEG-800	CEG-1200
Hopper Spreader	7 - 10	CEG-800	CEG-1200
Seed Tender	200 ft ³	CEG-800	CEG-1200
	100 ft ³	CEG-400	CEG-800
Truck Chute		CEG-400	CEG-800
Salt Spreader Pick-up Truck	1	CEG-400	CEG-400

Installation made EASY with Factory-Ready Installation Kits

Vibrator Model	Voltage	Kit Number	Duty Cycle
CEG-400-12	12 Volt	459220 ^B	Momentary Contact
CEG-800-12	12 Volt	459222 ^B	Maintained Contact
CEG-1200-12			
CEG-400-24	24 Volt	459240 ^B	Momentary Contact
CEG-800-24	24 Volt	459242 ^B	Maintained Contact
CEG-1200-24			
CEG-2000-12 ^A	12 Volt	459320 ^C	Momentary Contact
CEG-3200-12 ^A	12 Volt	459321 ^C (incl. extra-long 50 ft. cable)	Momentary Contact
CEG-4200-12 ^A			

^A CEG-2000, 3200, and 4200 are rated for intermittent use only.

^B Contains pre-drilled channel mount plate.

^C Contains drilled and tapped flat stock mount plate.

CEG-400,800, and 1200 are continuous duty motors. For intermittent use cycles select kit with momentary contact switch.

Kits include: Intermittent or Continuous Switch, 25 feet of #4 or #6 Battery Cable, Crimp Connectors, Flat Stock or Channel Mount Plate, and Mount Bolt Assemblies.

CEG-400, 800, and 1200 Continuous Duty Models



CEG-2000, 3200, and 4200 Intermittent Duty Models

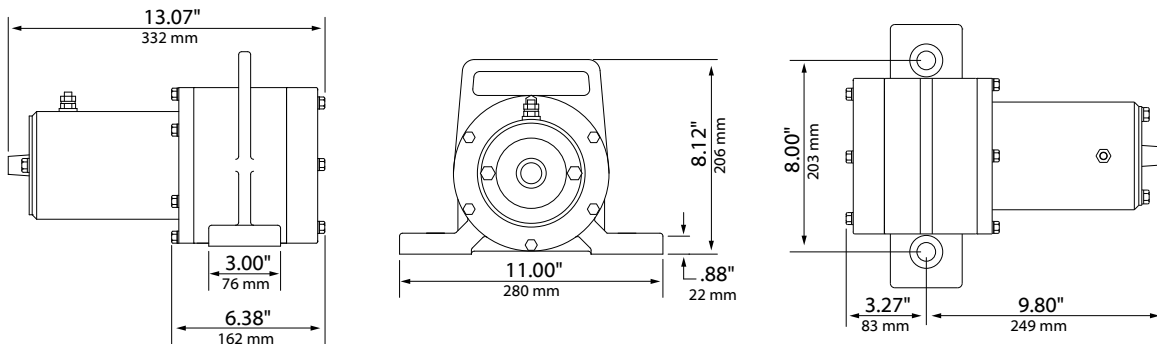

12 Volt DC Intermittent Duty Vibrators

Performance Data

VIBRATOR MODELS	Unbalance	Speed	Force	Voltage	Amp Draw
	lb/in	rpm	lb	volts	amps
	kg/mm	rpm	kN		
CEG-2000-12	2.96	5000	2102	12V DC	60
	341		9.35		
CEG-3200-12	4.55	5000	3231	12V DC	60
	524		14.37		
CEG-4200-12	6.06	5000	4303	12V DC	60
	698		19.14		

Force output is determined by the speed the motor rotates. Motor speed can be affected by the type and quality of the mount and the load on the motor. Follow manufacturer's guidelines for optimum performance.