

PNEUMATIC VIBRATOR PERFORMANCE DATA

MODEL	40 PSI (2.8 BAR)				60 PSI (4.1 BAR)				80 PSI (5.5 BAR)				MAXIMUM WEIGHT OF MATERIAL IN SLOPED PORTION
	UNBAL LB-IN (N-M)	START PSI (BAR)	SPEED RPM	FLOW SCFM (LPS)	FORCE LB (KN)	SPEED RPM	FLOW SCFM (LPS)	FORCE LB (KN)	SPEED RPM	FLOW SCFM (LPS)	FORCE LB (KN)		
C3-6A-4AC	1.5 (0.17)	8 (0.55)	4400	41 (19)	820 (3.6)	5150	55 (26)	1130 (5.0)	5650	74 (35)	1360 (6.0)	13,600 LB (6,170 KG)	
	2.0 (0.23)	8 (0.55)	4310	40 (19)	1050 (4.7)	4980	54 (25)	1410 (6.3)	5500	73 (34)	1720 (7.6)	17,200 LB (7,800 KG)	
	2.5 (0.28)	8 (0.55)	4220	39 (18)	1260 (5.6)	4820	53 (25)	1650 (7.3)	5350	72 (34)	2030 (9.0)	20,300 LB (9,810 KG)	
	3.0 (0.34)	8 (0.55)	4130	38 (18)	1450 (6.5)	4650	52 (25)	1840 (8.2)	5200	71 (34)	2300 (10.3)	23,000 LB (10,400 KG)	
	4.0 (0.45)	10 (0.69)	4050	37 (17)	1860 (8.3)	4540	51 (24)	2340 (10.4)	5170	70 (33)	3040 (13.5)	30,400 LB (13,800 KG)	
	5.0 (0.57)	13 (0.90)	3980	36 (17)	2250 (10.0)	4440	51 (24)	2800 (12.5)	5130	70 (33)	3740 (16.6)	37,400 LB (17,000 KG)	
	6.0 (0.68)	18 (1.24)	3900	35 (16)	2590 (11.5)	4330	50 (24)	3220 (14.2)	5100	69 (33)	4430 (19.7)	44,300 LB (20,100 KG)	
D4.5-6-4AC CC4.5-6-4AC	6.0 (0.7)	18 (1.24)	3950	35 (16)	2660 (11.8)	4250	50 (24)	3080 (13.7)	4500	65 (31)	3450 (15.3)	34,500 LB (15,600 KG)	
D4.5-8-4AC CC4.5-8-4AC	8.0 (0.9)	18 (1.24)	3600	30 (14)	2940 (13.1)	3900	48 (22)	3460 (15.4)	4300	64 (30)	4200 (18.7)	42,000 LB (19,100 KG)	
D4.5-10-4AC CC4.5-10-4AC	10.0 (1.1)	18 (1.24)	3350	32 (15)	3190 (14.2)	3700	47 (22)	3890 (17.3)	3900	62 (29)	4320 (19.2)	43,200 LB (19,600 KG)	
D7-12-6AC CC7-12-6AC	12.0 (1.4)	15 (1.04)	4000	55 (26)	5450 (24.2)	5250	85 (40)	9390 (41.8)	Operation Not Recommended at pressures above 60 PSI			(93,900 LB (42,600 KG))	
D7-18-6AC CC7-18-6AC	18.0 (2.0)	18 (1.24)	3550	54 (25)	6440 (28.6)	4650	82 (39)	11050 (49.2)	5400	114 (54)	14910 (66.3)	149,100 LB (67,600 KG)	
D7-25-6AC CC7-25-6AC	25.0 (2.8)	20 (1.38)	3300	52 (24)	7730 (34.4)	4400	81 (38)	13750 (61.2)	5050	109 (51)	18110 (80.6)	181,100 LB (82,100 KG)	
D7-50-6AC CC7-50-6AC	50.0 (5.7)	25 (1.73)	2700	48 (22)	10350 (46.0)	3750	67 (32)	19970 (88.8)	4350	93 (44)	26870 (120)	268,700 LB (121,900 KG)	

HYDRAULIC VIBRATOR PERFORMANCE DATA

MODEL	UNBAL LB-IN (N-M)	START PSI (BAR)	SPEED RPM	FLOW GPM (LPM)	FORCE LB (KN)	SPEED RPM	FLOW GPM (LPM)	FORCE LB (KN)	SPEED RPM	FLOW GPM (LPM)	FORCE LB (KN)	MAXIMUM WEIGHT OF MATERIAL IN SLOPED PORTION
C3-6A-2HC	1.5 (0.17)	80 (5.5)	3000	1.7 (6.3)	380 (1.7)	4000	2.2 (8.5)	680 (3.0)	5000	2.8 (10.6)	1070 (4.7)	10,700 LB (4,850 KG)
	2.0 (0.23)	105 (7.2)	3000	1.7 (6.3)	510 (2.3)	4000	2.2 (8.5)	910 (4.0)	5000	2.8 (10.6)	1420 (6.3)	14,200 LB (6,440 KG)
	2.5 (0.28)	130 (9.0)	3000	1.7 (6.3)	640 (2.8)	4000	2.2 (8.5)	1140 (5.1)	5000	2.8 (10.6)	1780 (7.9)	17,800 LB (8,070 KG)
	3.0 (0.34)	155 (11)	3000	1.7 (6.3)	770 (3.4)	4000	2.2 (8.5)	1360 (6.1)	5000	2.8 (10.6)	2130 (9.5)	21,300 LB (9,660 KG)
	4.0 (0.45)	200 (14)	3000	1.7 (6.3)	1020 (4.5)	4000	2.2 (8.5)	1820 (8.1)	5000	2.8 (10.6)	2840 (12.6)	28,400 LB (12,900 KG)
	5.0 (0.57)	250 (17)	3000	1.7 (6.3)	1280 (5.7)	4000	2.2 (8.5)	2270 (10.1)	5000	2.8 (10.6)	3550 (15.8)	35,500 LB (16,100 KG)
	6.0 (0.68)	300 (21)	3000	1.7 (6.3)	1530 (6.8)	4000	2.2 (8.5)	2730 (12.1)	5000	2.8 (10.6)	4260 (19.0)	42,600 LB (19,300 KG)
D4.5-6-5HC CC4.5-6-5HC	6.0 (336)	110 (7.6)	3000	5.0 (19)	1530 (6.8)	4000	6.7 (25)	2730 (12.1)	5000	8.4 (32)	4260 (19.0)	42,600 LB (19,300 KG)
D4.5-8-5HC CC4.5-8-5HC	8.0 (448)	140 (9.7)	3000	5.0 (19)	2040 (9.1)	4000	6.7 (25)	3640 (16.2)	5000	8.4 (32)	5680 (25.3)	56,800 LB (25,800 KG)
D4.5-10-5HC CC4.5-10-5HC	10.0 (560)	180 (12.4)	3000	5.0 (19)	2560 (11.4)	4000	6.7 (25)	4540 (20.2)	5000	8.4 (32)	7100 (31.6)	71,000 LB (32,200 KG)
D7-12-8HC CC7-12-8HC	12.0 (672)	120 (8.3)	3000	9.1 (34)	3070 (13.7)	4000	12.1 (46)	5450 (24.3)	5000	15.1 (57)	8520 (37.9)	85,200 LB (38,600 KG)
D7-18-8HC CC7-18-8HC	18.0 (1008)	180 (12.4)	3000	9.1 (34)	4600 (20.5)	4000	12.1 (46)	8180 (36.4)	5000	15.1 (57)	12780 (56.9)	127,800 LB (58,000 KG)
D7-25-8HC CC7-25-8HC	25.0 (1400)	250 (17.2)	3000	9.1 (34)	6390 (28.4)	4000	12.1 (46)	11360 (50.6)	5000	15.1 (57)	17750 (79.0)	177,500 LB (80,500 KG)
D7-50-8HC CC7-50-8HC	50.0 (2800)	490 (33.8)	3000	9.1 (34)	12780 (56.9)	4000	12.1 (46)	22720 (101.1)	5000	15.1 (57)	35500 (158.0)	355,000 LB (161,000 KG)

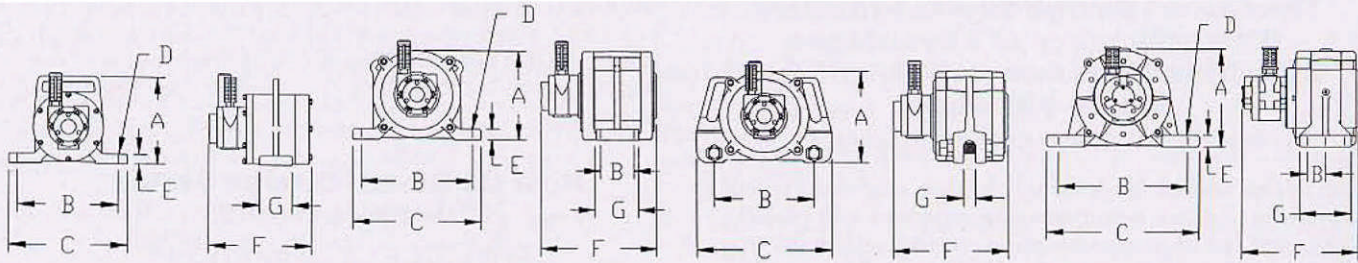

C3 — PNEUMATIC

D4.5 — PNEUMATIC

CC4.5 — PNEUMATIC

D7 — PNEUMATIC

GLOBAL DESIGN SERIES PNEUMATIC VIBRATORS SPECIFICATIONS

VIBRATOR MODEL	A	B	C	D	E	F	G	AIR MOTOR PORT SIZE (2 PORTS)	WEIGHT
	IN (MM)	IN (MM)	IN (MM)	IN (MM)	IN (MM)	IN (MM)	IN (MM)	NPT	LBS (KGS)
C3	8.2 (208)	8.0 (203)	11.1 (282)	0.78 (23)	0.9 (23)	9.6 (244)	3.0 (76)	1/2-14	44 (20)
D4.5	8.4 (213)	10.0 x 2.5 (254 x 64)	12.1 (307)	0.66 (17)	1.0 (25)	10.6 (343)	4.1 (104)	1/2-14	52 (24)
CC4.5	8.6 (218)	9.2 (234)	12.6 (320)	—	—	10.6 (270)	1.1 (28)	1/2-14	61 (28)
D7	11.5 (292)	16.0 x 2.0 (406 x 51)	18.0 (457)	0.78 (20)	1.4 (36)	13.5 (343)	6.0 (152)	3/4-14	104 (47)
CC7	11.5 (292)	11.5 (292)	14.8 (376)	—	—	13.5 (343)	1.1 (28)	3/4-14	96 (44)

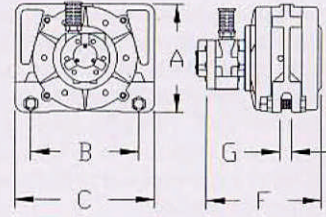

CC7 — PNEUMATIC

Weight: This is the total weight with largest eccentric mounted.

Weight will be less when a smaller eccentric is mounted.

D7 = Six bolt hole base vibrator.

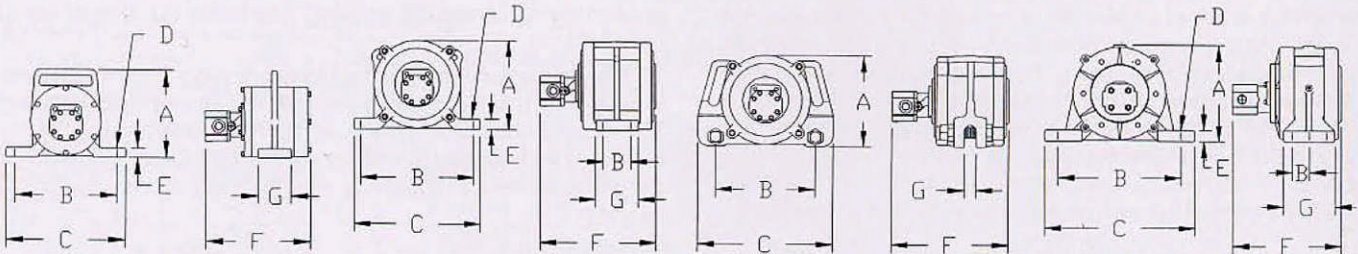

C3 — HYDRAULIC

D4.5 — HYDRAULIC

CC4.5 — HYDRAULIC

D7 — HYDRAULIC

GLOBAL DESIGN SERIES HYDRAULIC VIBRATORS SPECIFICATIONS

VIBRATOR MODEL	A	B	C	D	E	F	G	HYD MOTOR PORT SIZE (2 PORTS)	WEIGHT
	IN (MM)	IN (MM)	IN (MM)	IN (MM)	IN (MM)	IN (MM)	IN (MM)	SAE	LBS (KGS)
C3	8.2 (208)	8.0 (203)	11.1 (282)	0.78 (23)	0.9 (23)	9.2 (234)	3.0 (76)	3/4-16	40 (18)
D4.5	8.4 (213)	10.0 x 2.5 (254 x 64)	12.1 (307)	0.66 (17)	1.0 (25)	10.8 (274)	4.1 (104)	3/4-16	49 (22)
CC4.5	8.6 (218)	9.2 (234)	12.6 (320)	—	—	10.8 (274)	1.1 (28)	3/4-16	56 (25)
D7	11.5 (292)	16.0 x 2.0 (406 x 51)	18.0 (457)	0.78 (20)	1.4 (36)	13.0 (330)	6.0 (152)	3/4-14 NPTF	98 (45)
CC7	11.5 (292)	11.5 (292)	14.8 (376)	—	—	13.5 (343)	1.1 (28)	3/4-14 NPTF	90 (41)

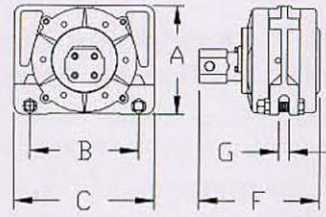

CC7 — HYDRAULIC

Weight: This is the total weight with largest eccentric mounted.

Weight will be less when a smaller eccentric is mounted.

D7 = Six bolt hole base vibrator.

CHICAGO VIBRATOR PRODUCTS
WESTMONT, IL

1-800-842-7284 US & CANADA
1-630-920-9411