

12 and 24 Volt DC Continuous Duty Truck Vibrators CEG 400-1200 Models

These Industrial Vibrators are Ideal for:
Dump and Hopper Trucks
Fertilizer Spreaders
Seed Tenders
Feed Hoppers
Concrete Pump
Salt Spreader Hoppers

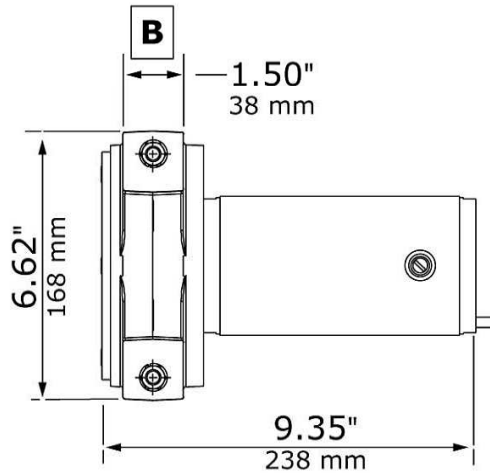
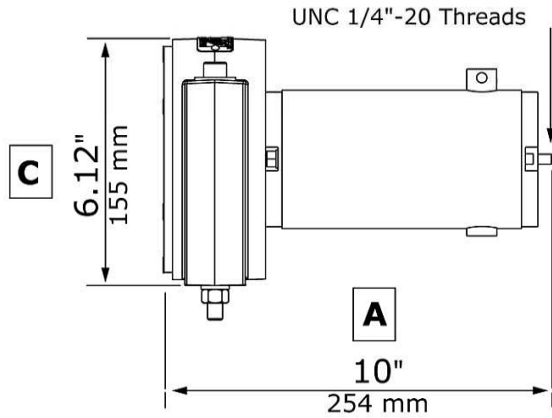
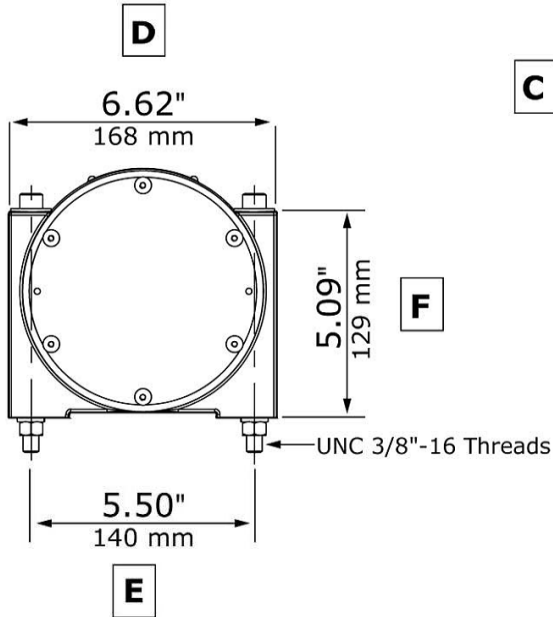

- Improve Productivity**
- more material delivered per load
- Improve Safety**
- helps ensure even unloading
- Eliminate Hammer Damage**
- vibrator does it all

12 Volt and 24 Volt DC Vibrator Dimensions

VIBRATOR MODEL	WEIGHT	A	B	C	D	E	F	G
		Total Length	Foot Width	Total Height	Total Width	Bolt Hole Separation Width	Foot Thickness	Bolt Hole Size
	lb	in	in	in	in	in	in	in
CEG All Models	15.1	10.0	1.50	6.12	6.62	5.50	5.09	.44
	6.8	246	38	155	168	140	129	11

12 and 24 Volt CEG Vibrators Performance Data

VIBRATOR MODEL	Unbalance	Speed	Force	Voltage	Amp Draw
	lb/in	rpm	lb	volts	amps
	kg/mm	rpm	kN	volts	amps
CEG-400-12	0.55	5400	455	12V DC	25
	63		2.03		
CEG-800-12	1.02	5400	845	12V DC	25
	118		3.76		
CEG-1200-12	1.44	5400	1193	12V DC	25
	166		5.03		
CEG-400-24	0.55	5400	455	24V DC	13
	63		2.03		
CEG-800-24	1.02	5400	845	24V DC	13
	118		3.76		
CEG-1200-24	1.44	5400	1193	24V DC	13
	166		5.30		

These newly designed Continuous Duty DC Truck Vibrators tolerate heavy loads without excessive amp draw. They keep working until you get the job done!

Great improvements in DC motors help these motors achieve high torque with reserve power

Heavy loads will not slow down this new DC motor design. Typically the heavier the load on the motor, the slower the motor rotates, drawing more amps, which can destroy a motor, but not with this Continuous Duty DC Industrial Vibrator.

This DC Motor design uses ball bearings, instead of sleeve bearings. Ball bearings allow for continuous duty operation.

Accessible, easy-to-change motor brushes.

Three sizes in the Continuous Duty models in either 12-volt or 24-volt.

Comes complete with an intermittent or continuous duty switch and cables everything you need to install on your truck, spreader, tender, or hopper.

12 and 24 Volt DC Intermittent Duty Truck Vibrators CEG 1800-4200 Models

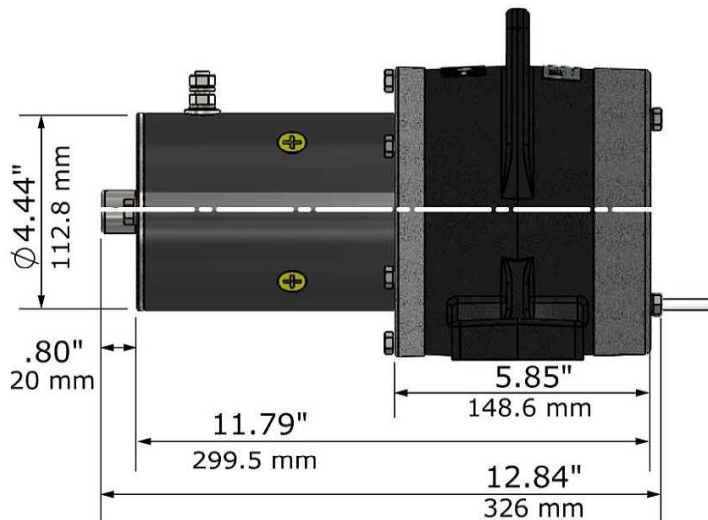
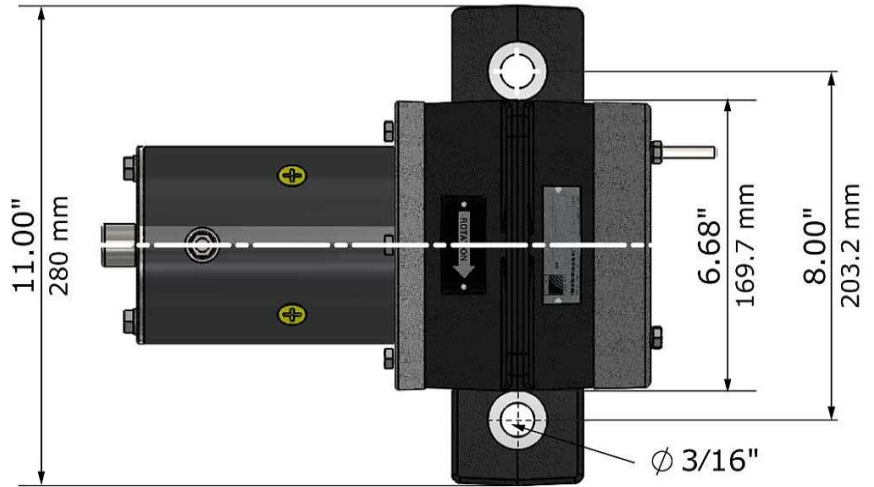
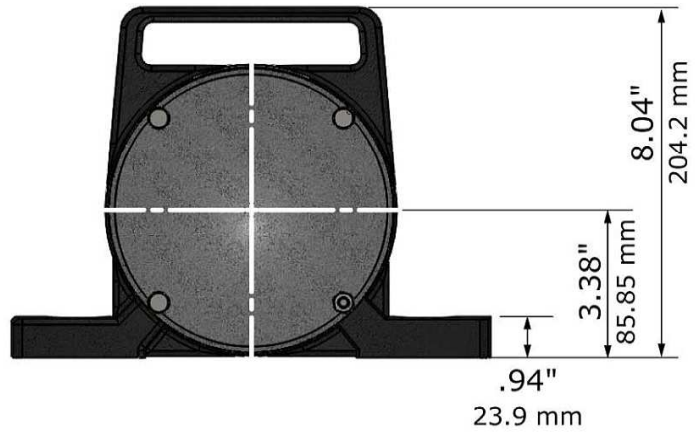

12 Volt DC Vibrators Performance Data

VIBRATOR MODEL	Speed	Unbalance	Force	Unbalance	Force	Unbalance	Force	Voltage	Amp Draw		
		min		med		max					
		lbf-in	lb	lbf-in	lb	lbf-in	lb			Volts	Amps
		kgf-mm	kN	kgf-mm	kN	kgf-mm	kN				
CEG-1800-12	5,000	1.50	1,065	2.00	1,420	2.50	1,775	12V DC	60		
		17	4.74	23	6.32	29	7.90				
CEG-2200-12	5,000	2.00	1,420	2.50	1,775	3.00	2,130	12V DC	60		
		23	6.32	29	7.90	35	9.47				
CEG-2800-12	5,000	2.50	1,775	3.00	2,130	4.00	2,840	12V DC	60		
		29	7.90	35	9.47	46	12.63				
CEG-3600-12	5,000	3.00	2,130	4.00	2,840	5.00	3,550	12V DC	60		
		35	9.47	46	12.63	58	15.79				
CEG-4200-12	5,000	4.00	2,840	5.00	3,550	5.89	4,182	12V DC	60		
		46	12.63	58	15.79	68	18.60				

Force output is determined by the speed the motor rotates. Motor speed can be affected by the type and quality of the mount and the load on the motor. Follow manufacturer's guidelines for optimum performance.

CHICAGO VIBRATOR PRODUCTS
 Division of CVP Group, Inc.
 Westmont, IL 60559
www.chicagovibrator.com
 800-842-7284
 866-247-7538 (F)
solutions@chivib.com