



D Series Bolt-on Style



C3 Series



CC Series – Clamp-on Style

Hydraulic Design Series Vibrators – Performance Data

VIBRATOR MODEL	UNBALANCE	START-UP	SPEED	FLOW	FORCE	SPEED	FLOW	FORCE	SPEED	FLOW	FORCE
	LB-IN	PSI	RPM	GPM	LBS	RPM	GPM	LBS	RPM	GPM	LBS
	N-M	BAR	---	LPM	KN	---	LPM	KN	---	LPM	KN
C3-1.5-2HC	1.5	80	3,000	1.7	380	4,000	2.2	680	5,000	2.8	1,070
	0.2	5.5	---	6.4	2	---	8.3	3	---	10.6	5
C3-2.0-2HC	2	105	3,000	1.7	510	4,000	2.2	910	5,000	2.8	1,420
	0.2	7.2	---	6.4	2	---	8.3	4	---	10.6	6
C3-2.5-2HC	2.5	130	3,000	1.7	640	4,000	2.2	1,140	5,000	2.8	1,780
	0.3	9	---	6.4	3	---	8.3	5	---	10.6	8
C3-3.0-2HC	3	155	3,000	1.7	770	4,000	2.2	1,360	5,000	2.8	2,130
	0.3	10.7	---	6.4	3	---	8.3	6	---	10.6	9
C3-4.0-2HC	4	200	3,000	1.7	1,020	4,000	2.2	1,820	5,000	2.8	2,840
	0.5	13.8	---	6.4	5	---	8.3	8	---	10.6	13
C3-5.0-2HC	5	250	3,000	1.7	1,280	4,000	2.2	2,270	5,000	2.8	3,550
	0.6	17.2	---	6.4	6	---	8.3	10	---	10.6	16
C3-6.0-2HC	6	300	3,000	1.7	1,530	4,000	2.2	2,730	5,000	2.8	4,260
	0.7	20.7	---	6.4	7	---	8.3	12	---	10.6	19
C3-1.5-5HC	1.5	0	3,000	5	380	4,000	6.7	680	5,000	8.4	1,070
	0.2	0	---	18.9	2	---	25.4	3	---	31.8	5
C3-2.0-5HC	2	0	3,000	5	510	4,000	6.8	910	5,000	8.4	1,420
	0.2	0	---	18.9	2	---	25.6	4	---	31.8	6
C3-2.5-5HC	2.5	0	3,000	5	640	4,000	6.7	1,140	5,000	8.4	1,780
	0.3	0	---	18.9	3	---	25.4	5	---	31.8	8
C3-3.0-5HC	3	0	3,000	5	770	4,000	6.7	1,360	5,000	8.4	2,130
	0.3	0	---	18.9	3	---	25.4	6	---	31.8	9
C3-4.0-5HC	4	0	3,000	5	1,020	4,000	6.7	1,820	5,000	8.4	2,840
	0.5	0	---	18.9	5	---	25.4	8	---	31.8	13
C3-5.0-5HC	5	0	3,000	5	1,280	4,000	6.7	2,270	5,000	8.4	3,550
	0.6	0	---	18.9	6	---	25.4	10	---	31.8	16
C3-6.0-5HC	6	0	3,000	5	1,530	4,000	6.7	2,730	5,000	8.4	4,260
	0.7	0	---	18.9	7	---	25.4	12	---	31.8	19
D4.5-6-5HC	6	110	3,000	5	1,530	4,000	6.7	2,730	5,000	8.4	4,260

CC4.5-6-5HC	0.7	7.6	---	18.9	7	---	25.4	12	---	31.8	19
D4.5-8-5HC	8	140	3,000	5	2,040	4,000	6.7	3,640	5,000	8.4	5,680
CC4.5-8-5HC	0.9	9.7	---	18.9	9	---	25.4	16	---	31.8	25
D4.5-10-5HC	10	180	3,000	5	2,560	4,000	6.7	4,540	5,000	8.4	7,100
CC4.5-10-5HC	1.1	12.4	---	18.9	11	---	25.4	20	---	31.8	32
D7-12-8HC	12	120	3,000	9.1	3,070	4,000	12.1	5,450	5,000	15.1	8,520
CC7-12-5HC	1.4	8.3	---	34.4	14	---	45.8	24	---	57.2	38
D7-18-8HC	18	180	3,000	9.1	4,600	4,000	12.1	8,180	5,000	15.1	12,780
CC7-18-8HC	2	12.4	---	34.4	20	---	45.8	36	---	57.2	57
D7-25-8HC	25	250	3,000	9.1	6,390	4,000	12.1	11,360	5,000	15.1	17,750
CC7-25-8HC	2.8	17.2	---	34.4	28	---	45.8	51	---	57.2	79
D7-50-8HC	50	490	3,000	9.1	12,780	4,000	12.1	22,720	5,000	15.1	35,500
CC7-50-8HC	5.7	33.8	---	34.4	57	---	45.8	101	---	57.2	158

Hydraulic Design Series Vibrators - Dimensional Data

VIBRATOR MODEL	WEIGHT	A	B	C	D	E	F	G	HYDRAULIC MOTOR PORT SIZE
		HEIGHT	LENGTH	WIDTH			BOLT HOLE	BOLT CENTERS	
	LBS	IN	IN	IN	IN	IN	IN	IN	IN
	KG	MM	MM	MM	MM	MM	MM	MM	
C3	40.00	8.2	11.10	9.20	3.00	0.9	0.78	8	3/4 - 16 SAE
	18.14	208.28	282	234	76.20	22.86	19.812	203.2	---
D4.5	49.00	8.4	12.10	10.80	4.10	1	0.66	---	3/4 - 16 SAE
	22.23	213.36	307	274	104.14	25.4	16.764	---	---
D7	98.00	11.5	18.00	13.00	6.00	1.4	0.78	---	3/4 - 14 NPT
	44.45	292.1	457	330	152.40	35.56	19.812	---	---
CC4.5	56.00	8.6	12.60	10.80	1.10	---	---	9.2	3/4 - 16 SAE
	25.40	218.44	320	274	27.94	---	---	233.68	---
CC7	90.00	11.5	14.80	13.50	1.10	---	---	11.5	3/4 - 14 NPT
	40.82	292.1	376	343	27.94	---	---	292.1	---

Hydraulic Design Series Vibrators			
Hydraulic Motor	2HC	5HC	8HC
Port Size	3/8" - 16 SAE O-RING	3/8" - 16 SAE O-RING	1/2" - 14 NPT
Minimum Hose Size	1/2" ID	5/8" ID	3/4" ID
Displacement	0.129 CU IN	0.388 CU IN	0.698 CU IN
---	2.11 CC	6.36 CC	11.43 CC
Maximum Speed	5,000 RPM	5,000 RPM	5,000 RPM
Flow at	2.8 GPM	8.4 GPM	15.1 GPM
Maximum Speed	17.7 LPM	38 LPM	69 LPM
Maximum Continuous Pressure	3,000 PSI	1,600 PSI	2,000 PSI
---	207 BAR	110 BAR	138 BAR
Maximum Intermittent Pressure	4,000 PSI	2,500 PSI	3,000 PSI
---	276 BAR	172 BAR	207 BAR
Maximum Back Pressure	350 PSI	350 PSI	350 PSI

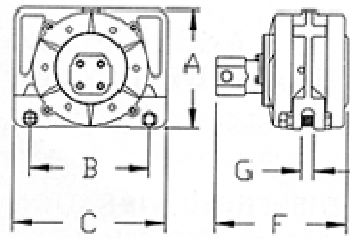

CC7 — HYDRAULIC

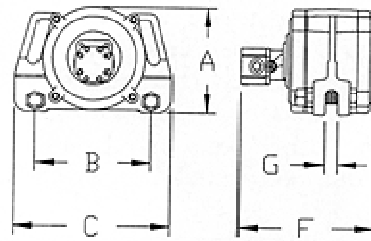

CC4.5 — HYDRAULIC

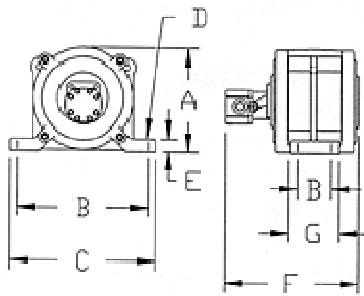

D4.5 — HYDRAULIC

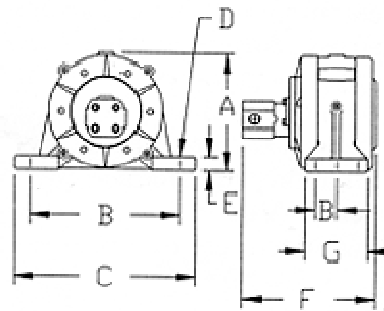

D7 — HYDRAULIC

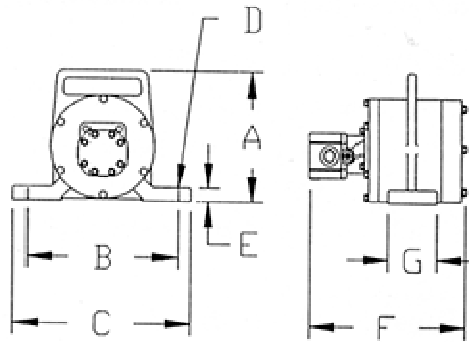

C3 — HYDRAULIC

CHICAGO VIBRATOR PRODUCTS

Division of CVP Group, Inc.

Westmont, IL 60559

www.chicagovibrator.com

800-842-7284

866-247-7538 (F)

solutions@chivib.com