

GW Air Blasters - Performance Data



STANDARD AIR BLASTER Performance Data						
AIR BLASTER MODEL	AIR PRESSURE	PSI	70	80	90	100
		BAR	4.8	5.5	6.2	6.9
GW2.5-8-24 Tank Volume = 0.7 cu ft (19 l)	FREE AIR VOLUME	CU FT	3.2	3.7	4.1	4.6
		LITERS	91	104	117	130
	FILL TIME	SEC	< 10	< 10	< 10	< 10
	SHOT TIME	SEC	0.08	0.09	0.09	0.09
	FORCE	LBS	244	275	288	330
		KN	1.09	1.23	1.29	1.48
	Efficiency	lbs/cu ft	76	75	70	72
GW4-12-28 Tank Volume = 1.7 cu ft (49 l)	FREE AIR VOLUME	CU FT	8.2	9.4	10.5	11.7
		LITERS	232	265	298	331
	FILL TIME	SEC	15	15	15	15
	SHOT TIME	SEC	0.08	0.08	0.08	0.08
	FORCE	LBS	877	1021	1200	1300
		KN	3.93	4.58	5.28	5.83
	Efficiency	lbs/cu ft	107	109	114	111
GW4-20-30 Tank Volume = 5 cu ft (142 l)	FREE AIR VOLUME	CU FT	23.8	23.8	23.8	23.8
		LITERS	675	675	675	675
	FILL TIME	SEC	35	40	40	40
	SHOT TIME	SEC	0.18	0.2	0.21	0.22
	FORCE	LBS	1075	1350	1485	1635
		KN	4.82	6.05	6.66	7.33
	Efficiency	lbs/cu ft	45	50	48	48
GW6-24-48 Tank Volume = 10.6 cu ft (299 l)	FREE AIR VOLUME	CU FT	50.2	57.4	64.6	71.7
		LITERS	1422	1625	1828	2031
	FILL TIME	SEC	90	90	90	105
	SHOT TIME	SEC	0.2	0.21	0.22	0.23
	FORCE	LBS	2681	2812	3230	3333
		KN	12.02	12.6	14.48	14.94
	Efficiency	lbs/cu ft	53	49	50	46
GW6-30-60 Tank Volume = 22.8 cu ft (645 l)	FREE AIR VOLUME	CU FT	108.5	124	139.5	155
		LITERS	3073	3511	3950	4389
	FILL TIME	SEC	210	210	210	210
	SHOT TIME	SEC	0.38	0.4	0.42	0.44
	FORCE	LBS	3190	3345	3840	3965
		KN	14.3	14.99	17.21	17.77
	Efficiency	lbs/cu ft	29	27	28	26

FILL TIME = Time to fill tank within +/- 2 psi of regulated pressure using 3/8" x 10' fill line. Fill time may vary depending on fill line size and length, compressor characteristics, and environmental conditions.

FORCE measurements were made using an 8" diameter, 1" thick piston, located 4" from the Air Blaster discharge mount flange, to transfer the blast impulse to a dynamic sensor. A 1" solenoid valve, without muffler, mounted directly to the air inlet port was used to fire the Air Blasters.

FILL TIME, SHOT TIME, & FORCE for the GW6-30-60 were **not measured**. The data presented is an **estimation of performance** for this model.

GW Air Blasters - Dimensional Data

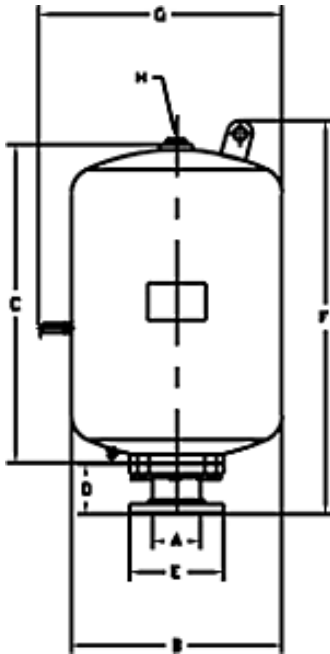

GW Models

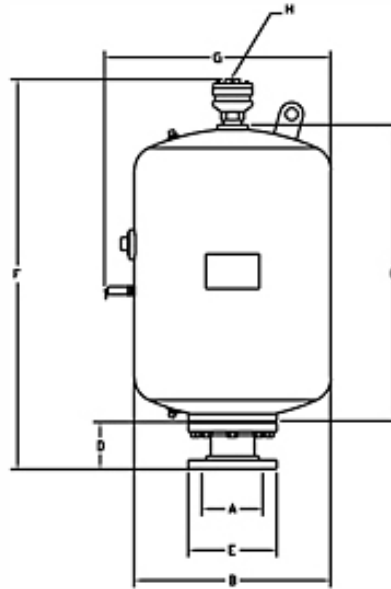

GWE Models

STANDARD AIR BLASTER Dimensions									
AIR BLASTER MODEL		A	B	C	D	E	F	G	H
	WEIGHT	DISCHARGE SIZE	TANK DIAMETER	TANK LENGTH	COUPLING LENGTH	FLANGE DIAMETER	TOTAL LENGTH	TOTAL WIDTH	INLET PORT
	LBS	IN	IN	IN	IN	IN	IN	IN	IN
	KG	MM	MM	MM	MM	MM	MM	MM	NPT
2.5" DISCHARGE:									
GW2.5-8-24	56	2.5	8	24	4.5	7	31.2	9.5	3/4
	25	64	203	610	114	178	792	241	NPT
4.0" DISCHARGE:									
GW4-12-28	94	4.0	12	28	4.6	9	35.3	13.5	3/4
	43	102	305	711	117	229	897	343	NPT
GW4-20-30	128	4.0	20	30	4.6	9	37.3	21.5	3/4
	58	102	508	762	117	229	947	546	NPT
6.0" DISCHARGE:									
GW6-24-48	260	6.0	24	48	6.0	11	56.7	25.6	1
	118	152	610	1219	152	279	1440	650	NPT
GW6-30-60	554	6.0	30	60	6.0	11	68.7	31.5	1
	251	152	762	1524	152	279	1745	800	NPT

AIR BLASTER with QUICK EXHAUST VALVE Dimensions									
AIR BLASTER MODEL		A	B	C	D	E	F	G	H
	WEIGHT	DISCHARGE SIZE	TANK DIAMETER	TANK LENGTH	COUPLING LENGTH	FLANGE DIAMETER	TOTAL LENGTH	TOTAL WIDTH	INLET PORT
	LBS	IN	IN	IN	IN	IN	IN	IN	IN
	KG	MM	MM	MM	MM	MM	MM	MM	NPT
2.5" DISCHARGE:									
GW2.5-8- 24 w/ externally mounted 1" QEV	59	2.5	8	24	4.5	7	33.5	9.5	3/4
	27	64	203	610	114	178	851	241	NPT
4.0" DISCHARGE:									
GWE4-12- 28	97	4.0	12	28	4.6	9	37.6	13.5	3/4
	44	102	305	711	117	229	955	343	NPT
GWE4-20- 30	131	4.0	20	30	4.6	9	39.6	21.5	3/4
	59	102	508	762	117	229	1006	546	NPT
6.0" DISCHARGE:									
GWE6-24- 48	263	6.0	24	48	6.0	11	59.0	25.6	3/4
	119	152	610	1219	152	279	1499	650	NPT
GWE6-30- 60	557	6.0	30	60	6.0	11	71.0	31.5	3/4
	253	152	762	1524	152	279	1803	800	NPT